

# Un-Pack

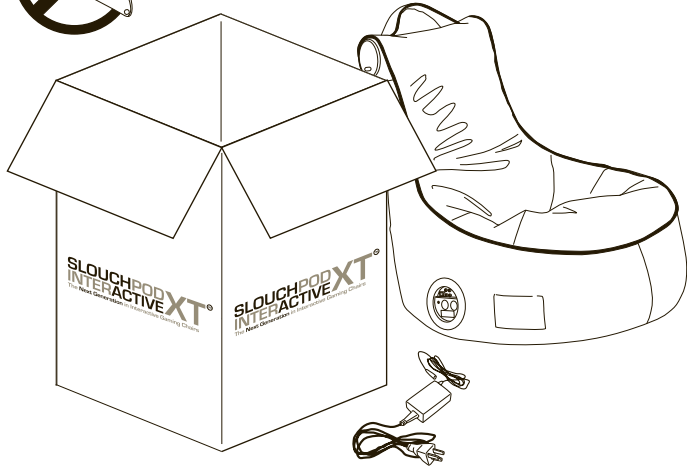

Do not use any sharp implement to remove outer packaging as this may cause damage to the product.



1. Remove chair and adaptor box from all packaging, and discard / Re-cycle outer packaging waste safely.
2. Check that your box contains:
  - 1 x Chair
  - 1 x 12v Adaptor
  - 1 x Red/White RCA audio connection cable
  - 1 x Red/White RCA to mini audio cable
  - 1 x 3.5mm mini jack plug to RCA plug adaptor
  - 2 x RCA audio cable extenders

# Power-Up

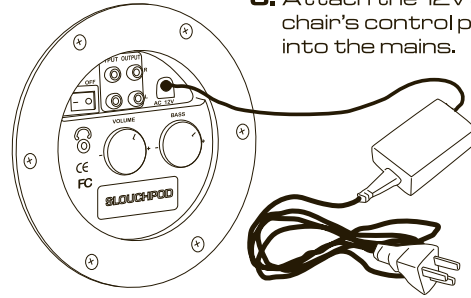

3. Attach the 12v adaptor to the chair's control panel and plug into the mains.

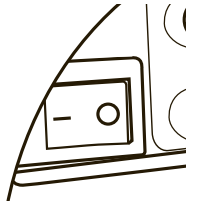

4. Switch on the power at the control panel.

# Get Connected



5. Connect the chair to required entertainment system. (Details overleaf)

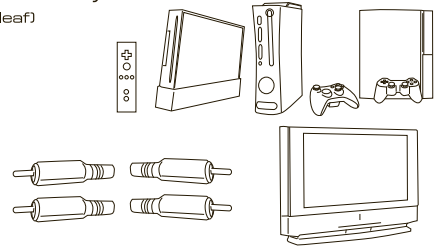

# QUICKSTART

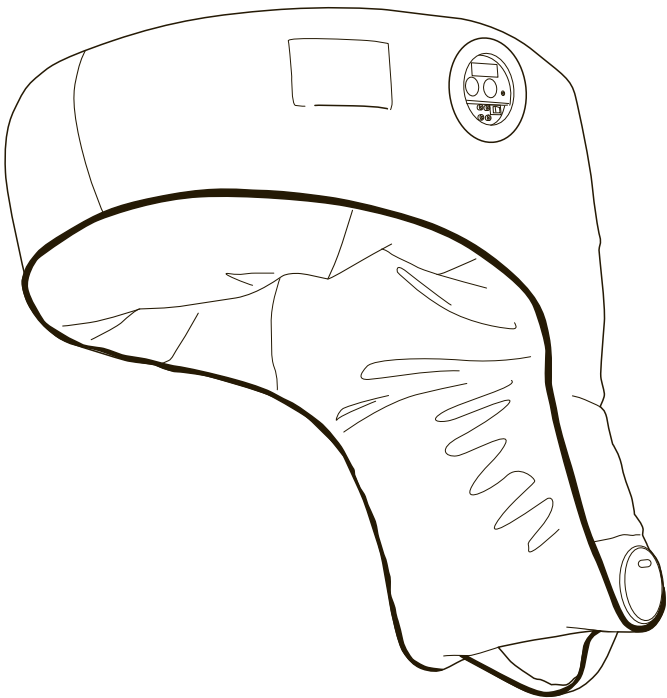

The Next Generation in Interactive Gaming Chairs  
**SLOUCHPOD XT**<sup>TM</sup>

## 6. SLOUCHPOD XT<sup>TM</sup> is now ready for use.

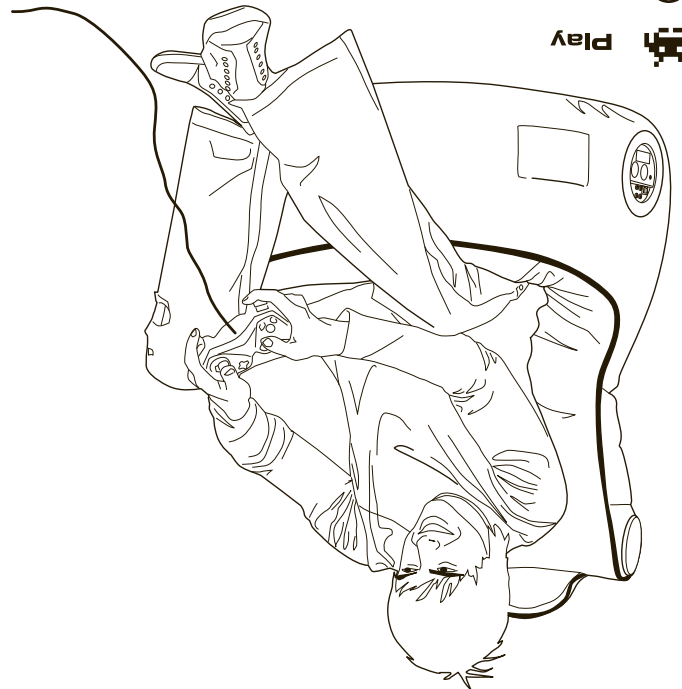

# Get Going

# Games Consoles

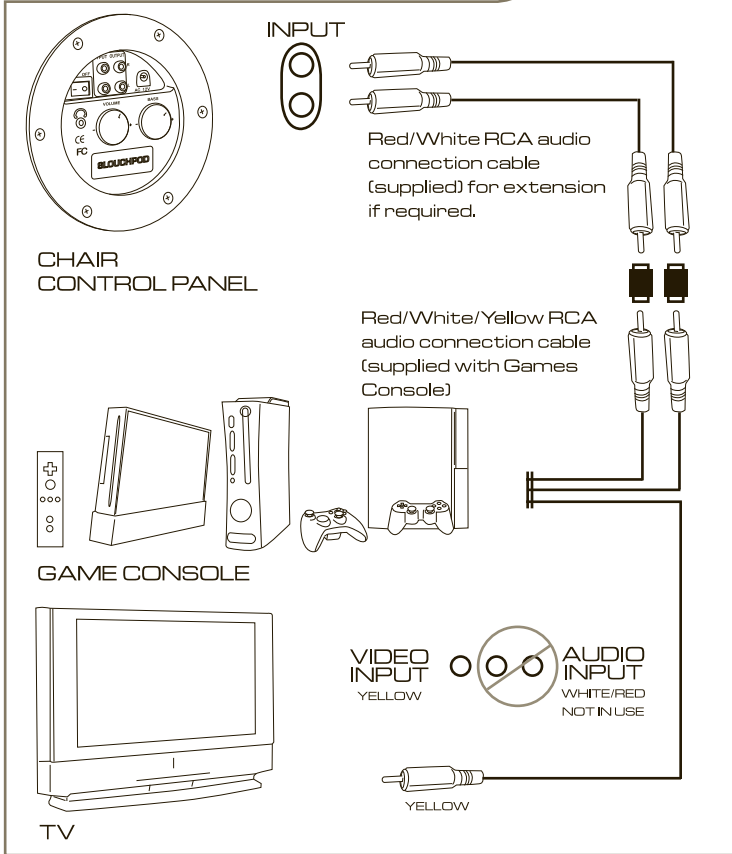

# Home Entertainment

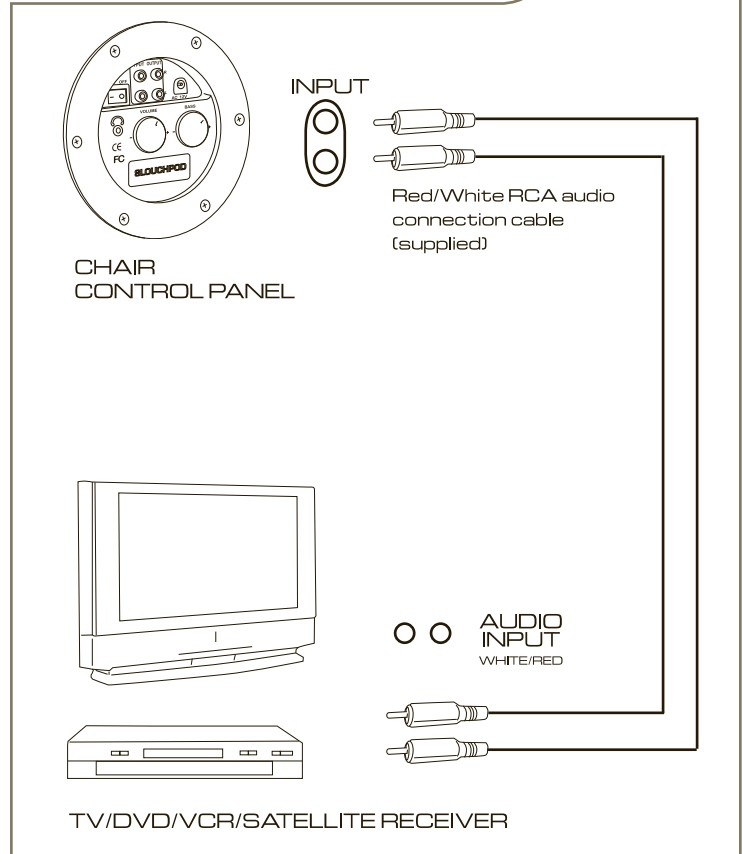

# Handheld Games MP3/CD Players

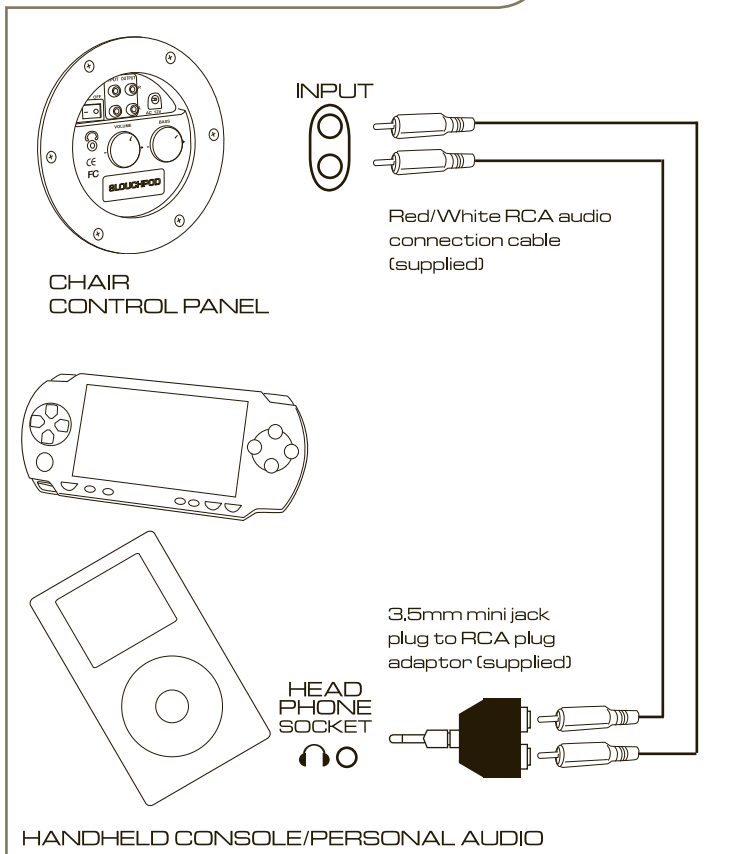

# Multi-User Connection

